



4/1-3 Glebe Avenue Goulburn NSW

2 1 1

* This neat and well-maintained two-storey townhouse offers a convenient, low-maintenance lifestyle just moments from the heart of town.

* Perfectly suited to first-home buyers, downsizers, or investors, the home combines practical design with comfortable modern living.

* Downstairs features an open plan layout, seamlessly integrating the living, dining, and kitchen areas to create a welcoming and functional space. This level also includes a handy powder room and excellent storage options throughout.

* Upstairs, two well-proportioned bedrooms with balconies provide peaceful retreats, both serviced by a central main bathroom complete with a separate toilet for added convenience.

Type : House
Price : \$589 000
Land Size : 181 sqm
View : <https://www.goulburnrealestate.com.au/sale/nsw/southern-tablelands/goulburn/residential/house/8683019>



Barry McEntee
02 4822 8711

[For full version visit the website](https://www.goulburnrealestate.com.au)

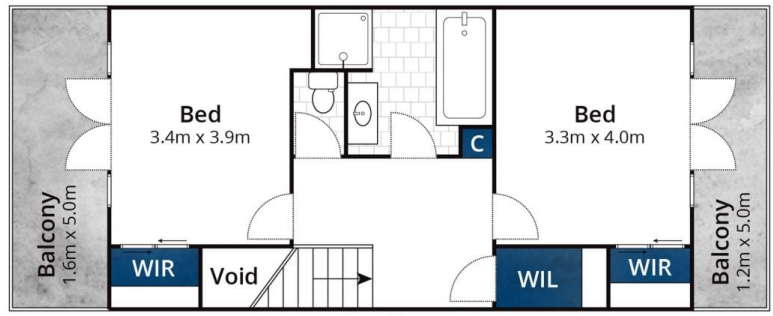

First Floor

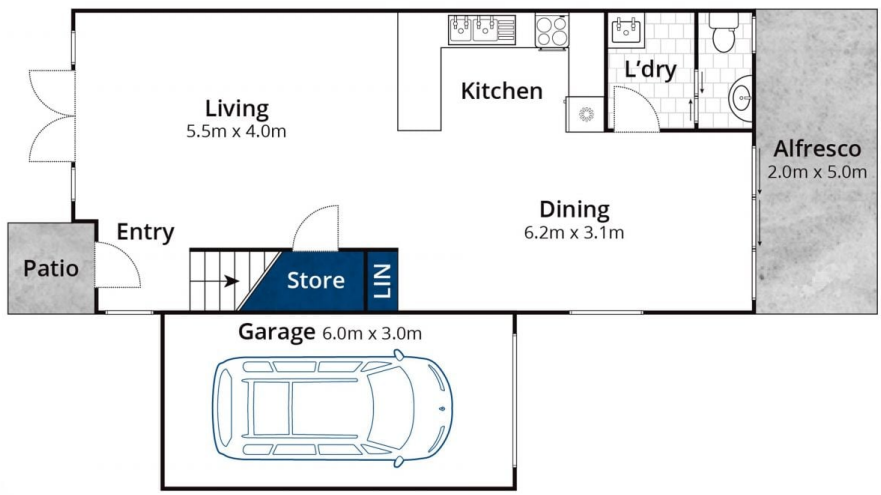

Ground Floor

Whilst bwrn.com.au has made every attempt to ensure the accuracy of the floor plan contained here, measurements are approximate and no responsibility is taken for any error, omission, or mis-statement. This plan is for illustrative purposes only.

4/1-3 Glebe Avenue, Goulburn

