



**6 Rosedale Court Goulburn NSW**

3 2 2

- \* Immaculate 3 bedroom home located in a quiet cul-de-sac in the popular West Goulburn precinct
- \* The block is 756m<sup>2</sup> and set on the high side of the road. There is ample side access which is perfect for a caravan and there is plenty of scope to build a shed in the low maintenance back yard
- \* Each of the bedrooms are a good size, there are built-in wardrobes and the main has an ensuite
- \* 2 separate living rooms with a lounge towards the front of the home complimented by open plan kitchen/dining/family room at the rear which opens to a large pergola and outdoor living space
- \* Double garage with auto entry and internal access to the home plus good climate control with gas heating and reverse cycle air conditioning

**Type** : House  
**Price** : \$ 737,500  
**Land Size** : 756 sqm  
**View** : <https://www.goulburnrealestate.com.au/8279925>



**Barry McEntee**  
02 4822 8711

[For full version visit the website](https://www.goulburnrealestate.com.au)

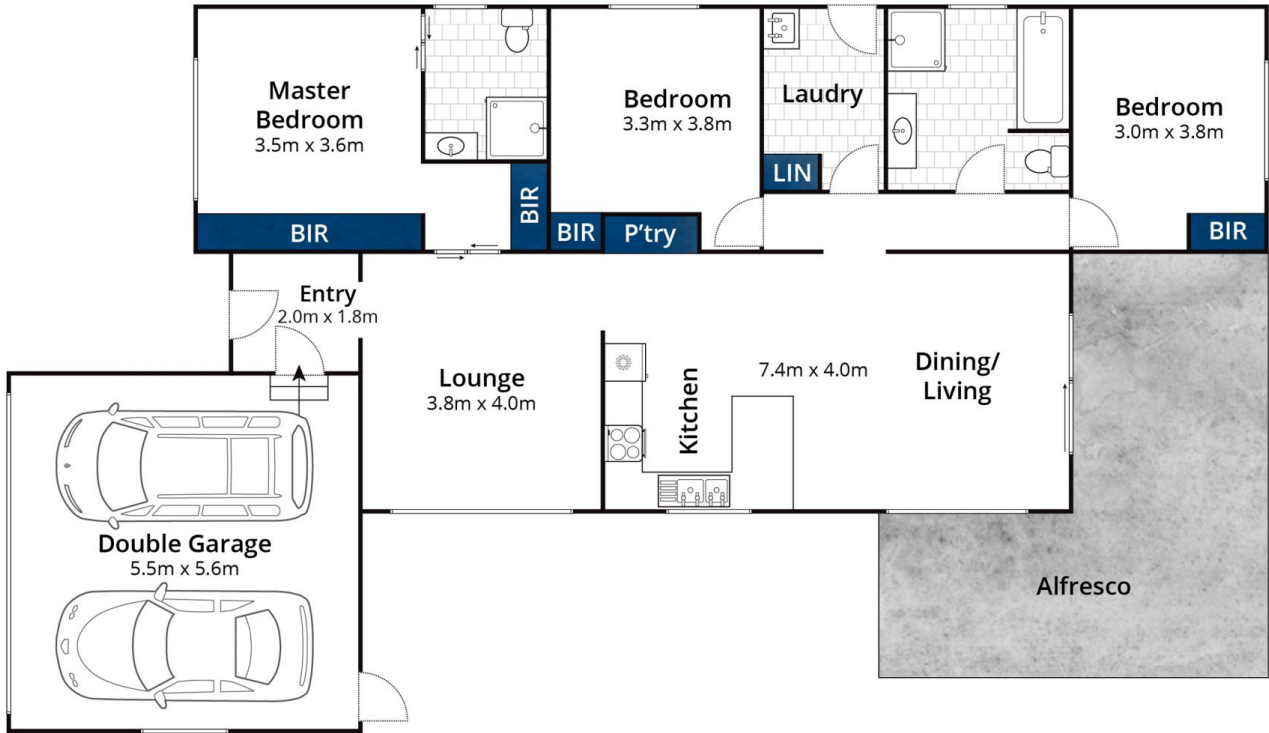

Approx House Area 149m<sup>2</sup>

Whilst [bwrn.com.au](http://bwrn.com.au) has made every attempt to ensure the accuracy of the floor plan contained here, measurements are approximate and no responsibility is taken for any error, omission, or mis-statement. This plan is for illustrative purposes only.

## 6 Rosedale Court, Goulburn