



**16a Madeleine Drive Goulburn NSW**

4 2 2

- \* Architecturally designed home with a level of finish above and beyond the usual standard
- \* 4 bedrooms, all with built-in wardrobes and a walk-through wardrobe plus ensuite to the main
- \* Open plan, living kitchen and dining complete with a large walk in pantry and stone benchtops with quality appliances
- \* 2.7m high ceilings and fully ducted reverse cycle air conditioning. A large media room allows flexibility with the floorplan
- \* Double garage with auto entry as well as internal access
- \* Ultra low maintenance with the peace of mind of being brand new in a quiet residential area.

**Type** : House  
**Price** : \$ 720,000  
**Land Size** : 407 sqm  
**View** : <https://www.goulburnrealestate.com.au/sale/nsw/southern-tablelands/goulburn/residential/house/8056787>

Rental Appraisal: \$480 - \$510 pw approx

[For full version visit the website](#)



**Brody Willis**  
02 4822 8711

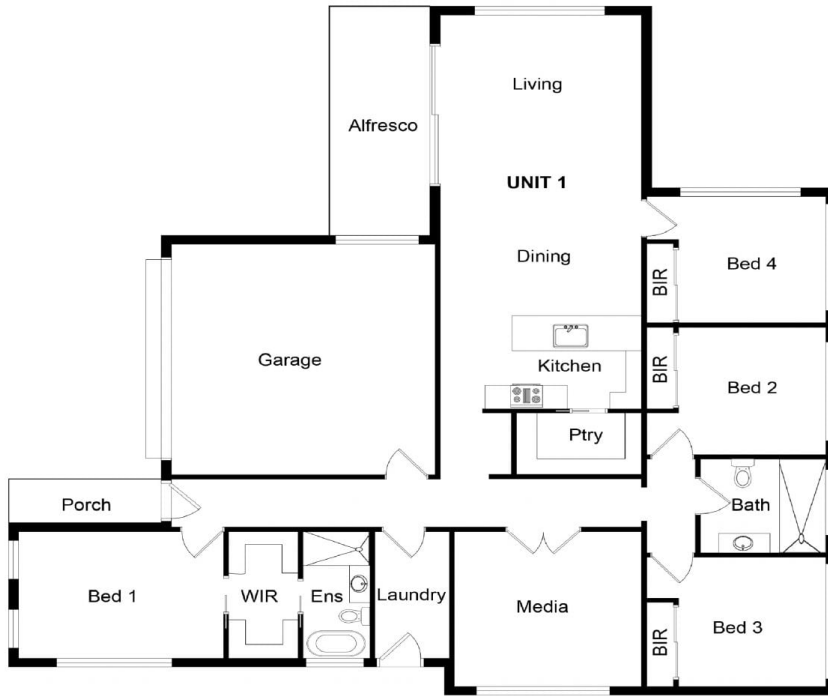

FLOOR PLAN

This floor plan including furniture, fixture measurements and dimensions are approximate and for illustrative purposes only.  
BoxBrownie.com gives no guarantee, warranty or representation as to the accuracy and layout.  
All enquiries must be directed to the agent, vendor or party representing this floor plan.