

23 Renshaw Street Goulburn NSW

3 1 4

* A fantastic opportunity for first home buyers or other entry level purchasers to secure a genuine 3 bedroom home with plenty of potential

* Located in a quiet street within close proximity to a number of key amenities including the popular Wollondilly Walking Track, both primary and secondary schools plus the Goulburn Base Hospital

* The 661m2 block has side access to a private rear yard which includes a very large garage which could accommodate up to 4 vehicles plus a secondary work shed which has been ideal for wood storage

* You will stay warm and cozy this Winter with a roaring wood fire and the home enjoys plenty of natural light courtesy of the sunny north east aspect

* This property is well priced given the excellent location

Type : House
Price : \$ 465,000
Land Size : 626 sqm
View : <https://www.goulburnrealestate.com.au/sale/nsw/southern-tablelands/goulburn/residential/house/8030215>



Barry McEntee
02 4822 8711



Bella Greig
02 4822 8711

[For full version visit the website](https://www.goulburnrealestate.com.au)

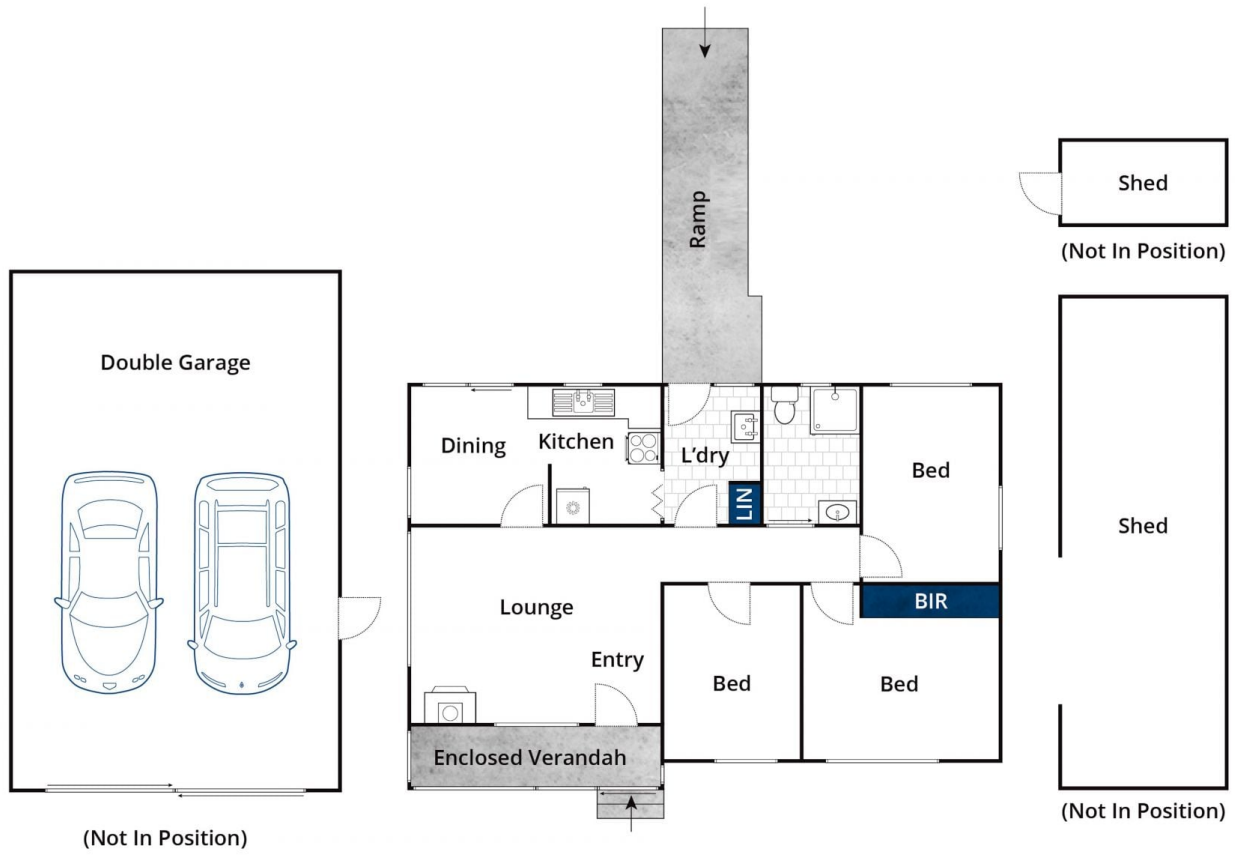

Whilst bwrn.com.au has made every attempt to ensure the accuracy of the floor plan contained here, measurements are approximate and no responsibility is taken for any error, omission, or mis-statement. This plan is for illustrative purposes only.

23 Renshaw Street, Goulburn