



14 Monastery Drive Goulburn NSW

4 2 2

- * A rare offering with this brick 4 bedroom home. Built to a very high standard on over 1000m2 of established land
- * Oversized living areas that are flooded with natural light along with a north facing, enclosed alfresco area that overlooks the stunning garden. The size of the property needs to be seen to be appreciated
- * The master suite comes complete with generous walk-in wardrobes as well as a full ensuite bathroom
- * Climate controlled with ducted heating and evaporative cooling throughout the home
- * The large, well appointed kitchen is the hub of the home and offers a 900mm gas cooktop along with stainless steel oven and dishwasher. It has an abundance of work space and storage which benefits from a walk-in pantry
- * A double garage with internal access as well as an

Type : House
Price : \$ 835,000
Land Size : 1021 sqm
View : <https://www.goulburnrealestate.com.au/sale/nsw/southern-tablelands/goulburn/residential/house/7613335>



Brody Willis
02 4822 8711

[For full version visit the website](https://www.goulburnrealestate.com.au)

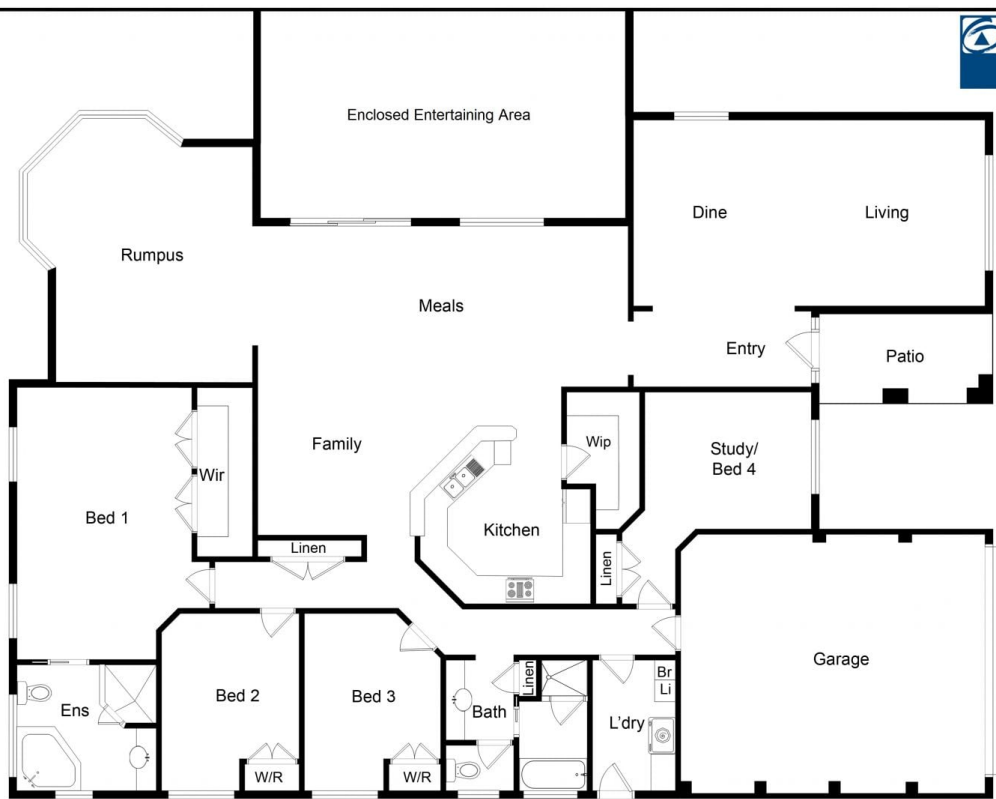

FLOOR PLAN

This floor plan including furniture, fixture measurements and dimensions are approximate and for illustrative purposes only.
Boxbrownie.com gives no guarantee, warranty or representation as to the accuracy and layout.
All enquiries must be directed to the agent, vendor or party representing this floor plan.

14 Monastery Drive, Goulburn