

**122 Clinton Street Goulburn NSW**

3 1 1

? 3 Bedroom, one bathroom, semi detached character cottage full of charm, and only minutes from the CBD  
 ? Recently updated to include an open plan dining, living area and kitchen  
 ? The property also boasts off street parking via a rear lane which allows the flexibility to add a shed or workshop if desired  
 ? A few minutes walk into the CBD but also conveniently located to take advantage of the Victoria Park precinct featuring new Aquatic Centre, Hospital, Adventure Park and so much more  
 ? Don't delay and book an inspection today.

**Type** : House  
**Price** : \$ 570,000  
**Land Size** : 467.9 sqm  
**View** : <https://www.goulburnrealestate.com.au/sale/nsw/southern-tablelands/goulburn/residential/house/7343931>

Rates - \$1415 pa approx

[For full version visit the website](#)



**Glenn Power**  
02 4822 8711

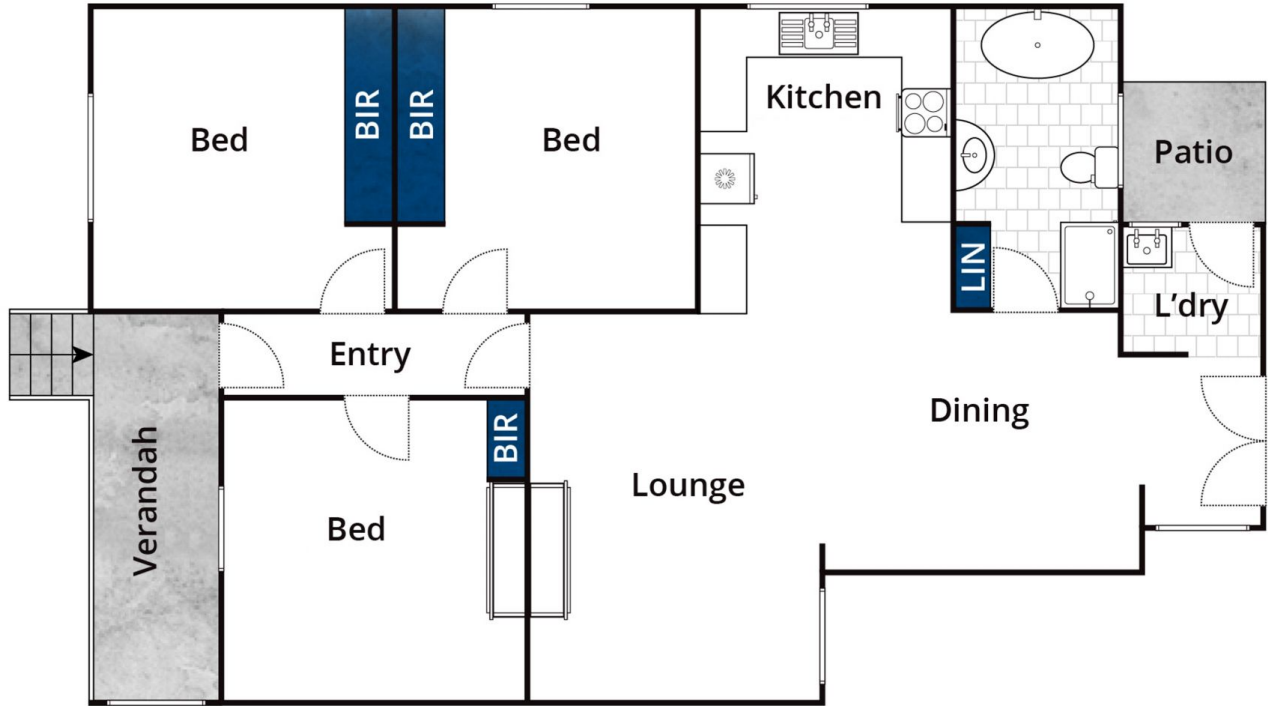

Whilst [bwrn.com.au](http://bwrn.com.au) has made every attempt to ensure the accuracy of the floor plan contained here, measurements are approximate and no responsibility is taken for any error, omission, or mis-statement. This plan is for illustrative purposes only.

## 122 Clinton Street, Goulburn