



**62 Slocombe Street Goulburn NSW**

4 2 10

\* Country living with city convenience - the best of both worlds. Perfectly positioned within one of Goulburn's most sought after locations less than 5 minutes drive to the heart of the CBD

\* Just over 1 acre of land (approx. 4047m<sup>2</sup>) set on the high side of the road with tremendous elevation and brilliant district views. The fully established block has no rear neighbours and offers privacy in a tranquil setting

\* This property is a great alternative for buyers who want a rural lifestyle without the work involved in looking after larger acreage - Colonial style homestead with wide verandas on all sides, colourbond roof and brilliant outdoor entertaining area

\* The 4 bedroom home offers plenty of space with most rooms oversize which in addition to the high ceilings and

**Type** : House  
**Price** : \$ 1,380,000  
**Land Size** : 4047 sqm  
**View** : <https://www.goulburnrealestate.com.au/sale/nsw/southern-tablelands/goulburn/residential/house/7205274>



**Barry McEntee**  
02 4822 8711

[For full version visit the website](https://www.goulburnrealestate.com.au)

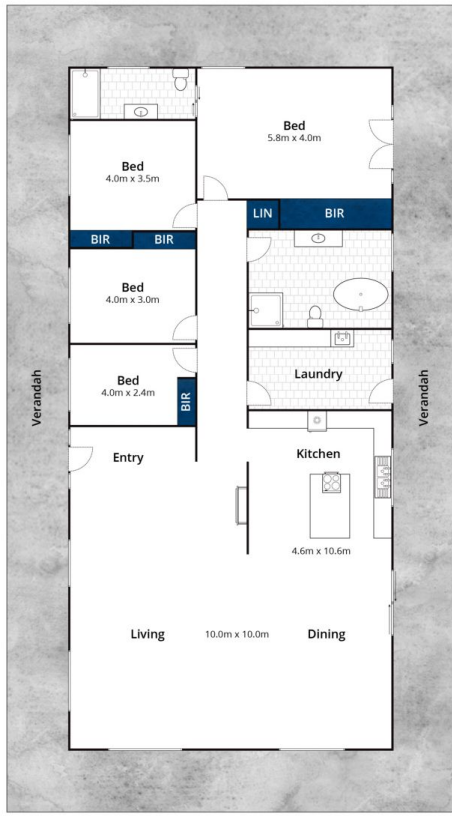

Ground Floor

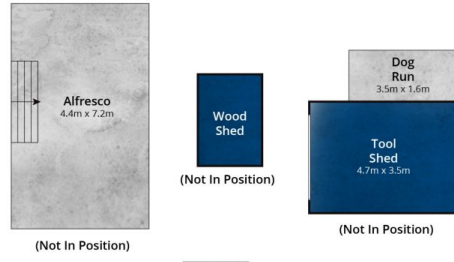

(Not In Position)

(Not In Position)

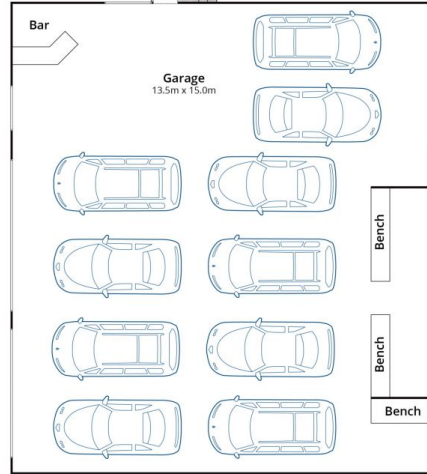

(Not In Position)

Approx House Area 226m<sup>2</sup>  
Approx Land Area 1 Acre

Whilst [bwrn.com.au](http://bwrn.com.au) has made every attempt to ensure the accuracy of the floor plan contained here, measurements are approximate and no responsibility is taken for any error, omission, or mis-statement. This plan is for illustrative purposes only.

## 62 Slocombe Street, Goulburn





Site Plan

Approx House Area 226m<sup>2</sup>  
Approx Land Area 1 Acre

Whilst [bwrn.com.au](http://bwrn.com.au) has made every attempt to ensure the accuracy of the floor plan contained here, measurements are approximate and no responsibility is taken for any error, omission, or mis-statement. This plan is for illustrative purposes only.

**62 Slocombe Street, Goulburn**

