



**10 Racecourse Drive Goulburn NSW**

3 2 2

\* An incredibly rare chance for those in the thoroughbred industry to capitalise on a combination of location, infrastructure and opportunity. Set within 200m of the highly regarded Goulburn and District Racing Club which boasts training facilities that are some of the best in the region. Just 2 hours from Sydney, 50 minutes to Canberra as well as being within reasonable access to most country and provincial Racecourses in NSW.

\* This property can currently house 15 horses undercover, with room to add more stabling if required as well as 5 well fenced day yards. The list of infrastructure includes a 6-horse walker, round yard, tack and hay shed along with ample parking for floats, truck and trailers. A solar system and no less that 25,000L of onsite water storage are added plusses.

**Type** : House  
**Price** : \$ 927,500  
**Land Size** : 4004 sqm  
**View** : <https://www.goulburnrealestate.com.au/sale/nsw/southern-tablelands/goulburn/residential/house/7139476>



**Brody Willis**  
02 4822 8711

[For full version visit the website](https://www.goulburnrealestate.com.au)

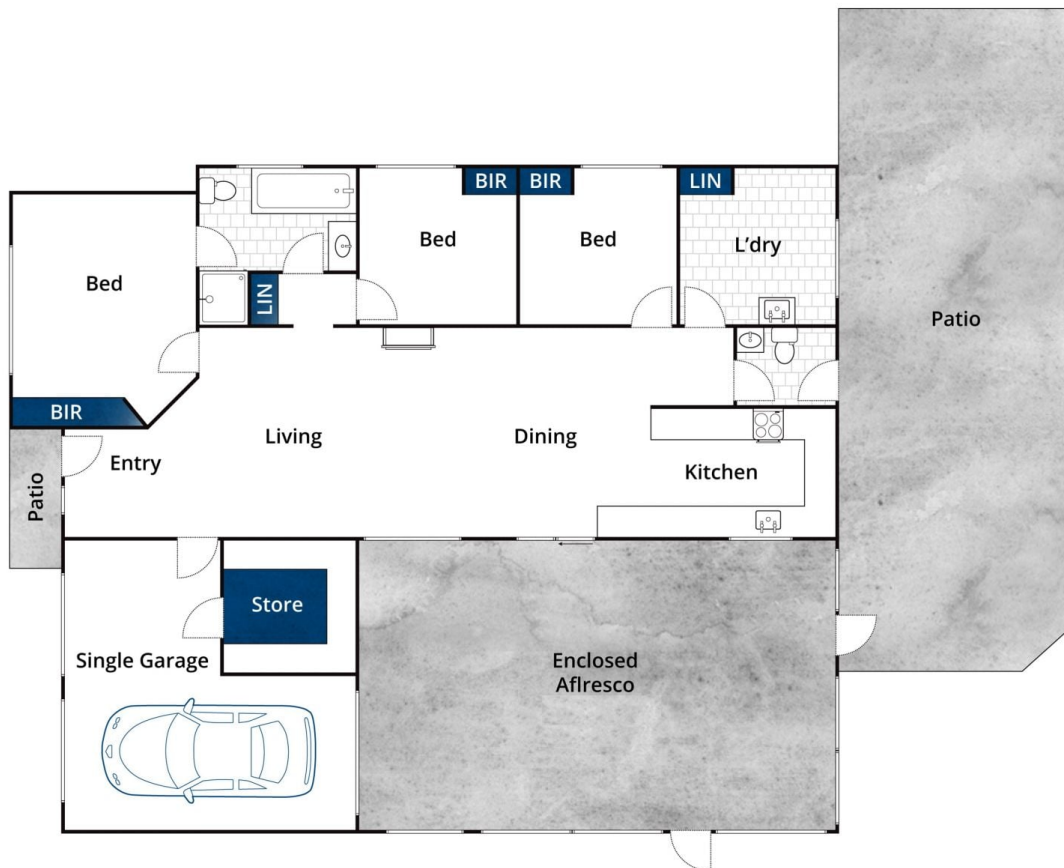

Whilst [bwrn.com.au](http://bwrn.com.au) has made every attempt to ensure the accuracy of the floor plan contained here, measurements are approximate and no responsibility is taken for any error, omission, or mis-statement. This plan is for illustrative purposes only.

## 10 Racecourse Drive, Goulburn

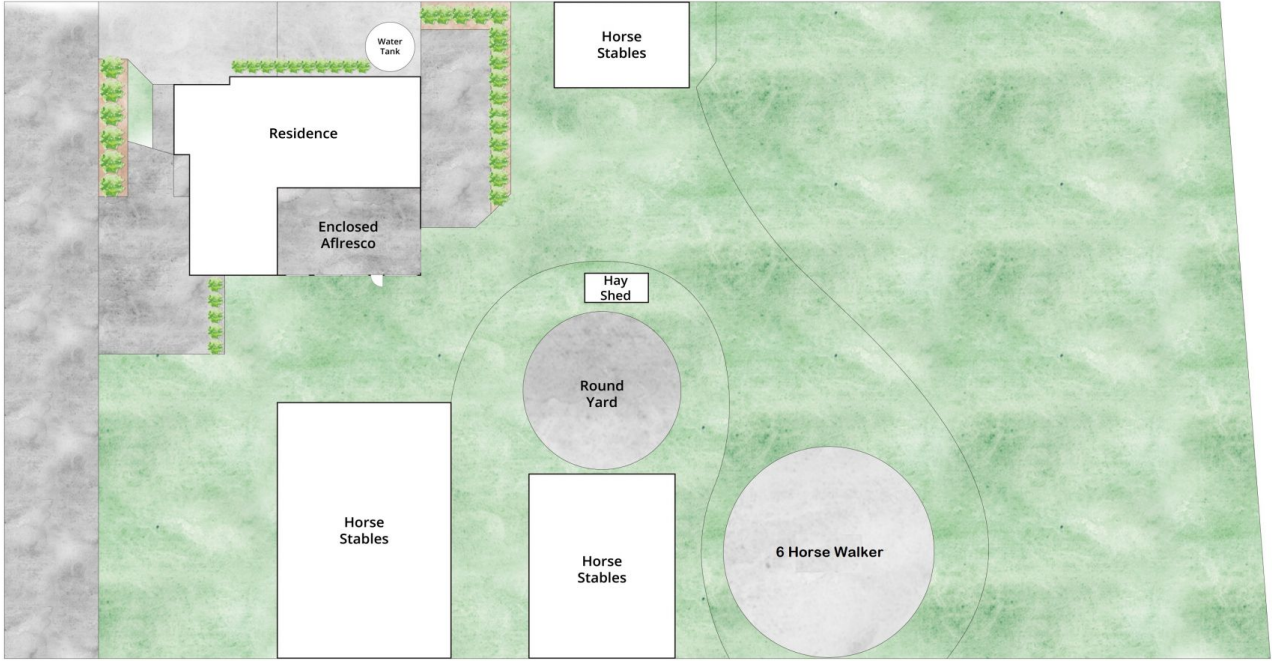

Approx Land Area 4004m<sup>2</sup>

Whilst [bwrn.com.au](http://bwrn.com.au) has made every attempt to ensure the accuracy of the floor plan contained here, measurements are approximate and no responsibility is taken for any error, omission, or mis-statement. This plan is for illustrative purposes only.

## 10 Racecourse Drive, Goulburn