



52 Constantina Circuit Goulburn NSW

4 2 2

- * Located in the highly sought after "River Heights" Estate this immaculate 4 bedroom family home has loads of appeal
- * The block is level and the 969m2 land size will be very sought after - almost a traditional quarter acre block
- * The flexible floor plan offers at least 3 separate living areas and a choice of both formal and casual dining areas
- * As you would expect the main bedroom offers an ensuite and walk-in robe - the other 3 bedrooms are located in a separate wing and are serviced by a large main bathroom
- * The north rear aspect offers plenty of natural light and there are 2 separate outdoor entertaining areas which are both fully undercover and protected from the elements
- * Loads of extras including double garage, 2 garden sheds, cosy wood fire and a huge solar system

Type : House
Price : \$ 750,000
Land Size : 969 sqm
View : <https://www.goulburnrealestate.com.au/sale/nsw/southern-tablelands/goulburn/residential/house/7135411>



Barry McEntee
02 4822 8711

[For full version visit the website](https://www.goulburnrealestate.com.au)

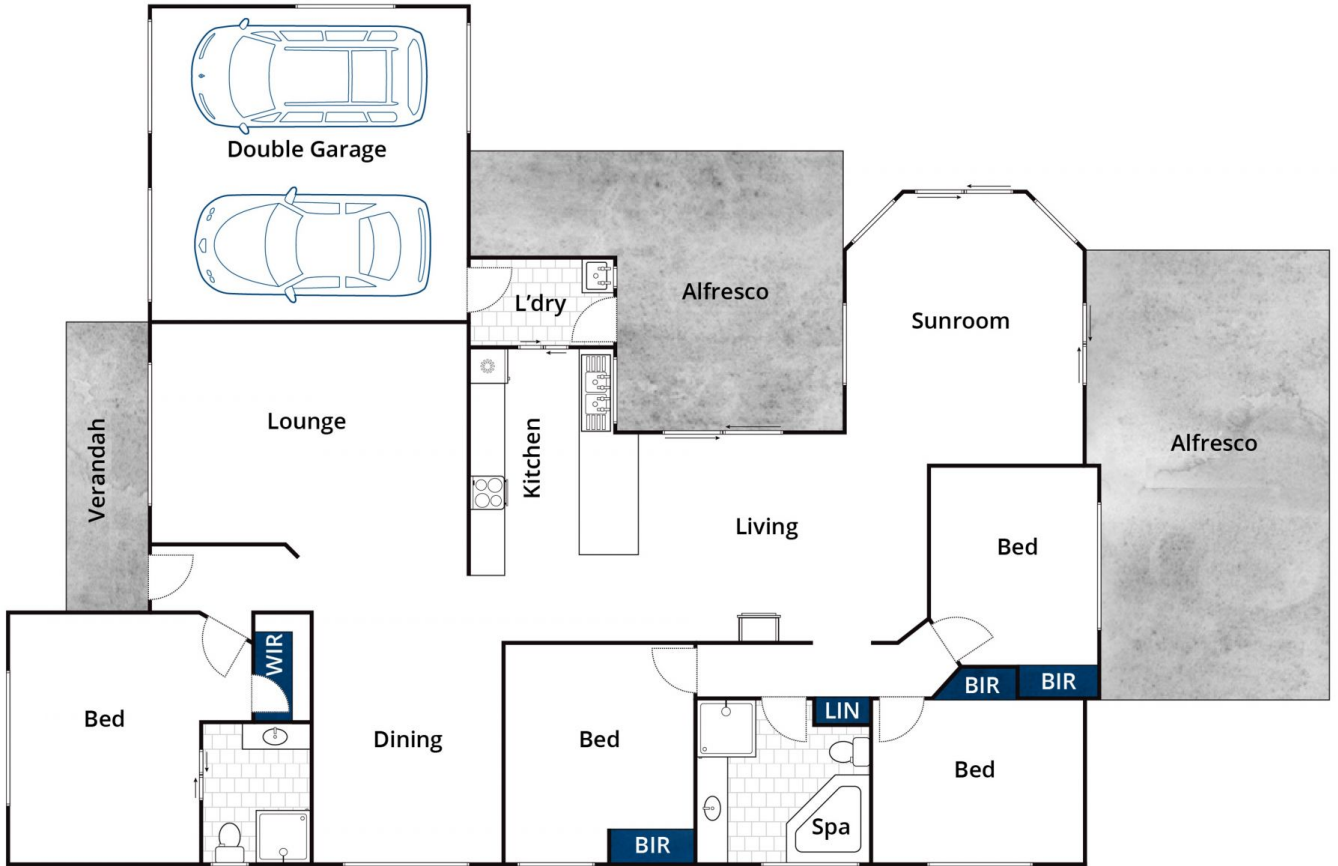

Whilst bwrn.com.au has made every attempt to ensure the accuracy of the floor plan contained here, measurements are approximate and no responsibility is taken for any error, omission, or mis-statement. This plan is for illustrative purposes only.

52 Constantina Circuit, Goulburn