

7 Glebe Avenue Goulburn NSW

3 1 1

- * "Ventura" - a wonderful example of authentic Federation architecture, literally a stone's throw to the CBD
- * You will be impressed by the period features both inside and out which include tessellated tiles on the front verandah, bluestone foundations, high patterned ceilings, wide polished floorboards, ornate timberwork, leadlight windows and original fireplaces
- * 3 good sized bedrooms and spacious open plan living and dining rooms all with the benefit of ducted gas heating
- * Renovated kitchen with stone benchtops and a wide 900mm oven plus modern bathroom complete with free standing claw foot bath. There is the added benefit of a second toilet in the laundry
- * Brilliant north rear aspect complements the large outdoor entertaining area which overlooks a fully landscaped yard

Type : House
Price : \$ 660,000
Land Size : 766.4 sqm
View : <https://www.goulburnrealestate.com.au/sale/nsw/southern-tablelands/goulburn/residential/house/7041145>



Barry McEntee
02 4822 8711

[For full version visit the website](https://www.goulburnrealestate.com.au)

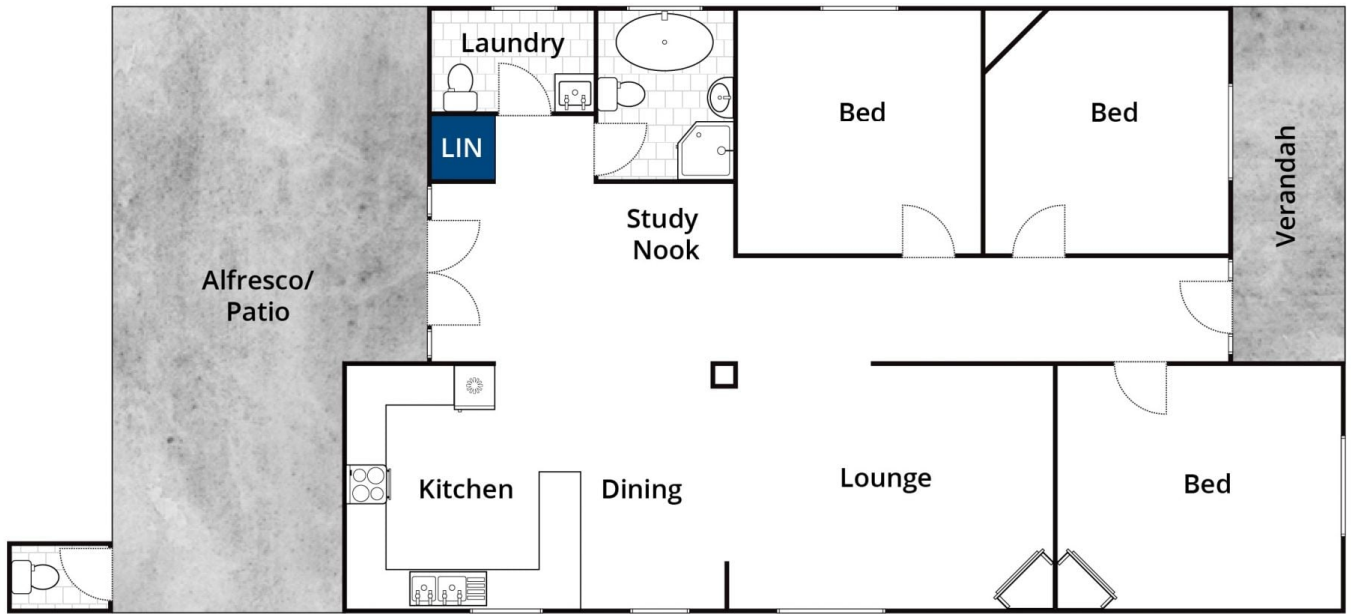

Whilst bwrn.com.au has made every attempt to ensure the accuracy of the floor plan contained here, measurements are approximate and no responsibility is taken for any error, omission, or mis-statement. This plan is for illustrative purposes only.

7 Glebe Avenue, Goulburn

