



8 Barry Crescent Goulburn NSW

4 2 2

* Set in a quiet and established location is this well kept, 4 bedroom family home. Close to schools, walking tracks and a short drive into the CBD. It also has 2 day care centres and a bus stop within walking distance

* Climate controlled with ducted reverse cycle air conditioning as well as a cosy wood fire with heat transfer system

* Modern kitchen with stainless steel appliances and gas cooking. Plenty of storage and bench space on offer

* A very large living room which offers flexibility due to its size. Could be used for several different purposes. A separate dining area is adjacent to the kitchen and flows out to the well appointed Alfresco area complete with roller blinds

* 4 Large bedrooms, 3 of which have built-in wardrobes

Type : House
Price : \$ 815,000
Land Size : 789.1 sqm
View : <https://www.goulburnrealestate.com.au/sale/nsw/southern-tablelands/goulburn/residential/house/6916287>



Brody Willis
02 4822 8711

[For full version visit the website](https://www.goulburnrealestate.com.au)

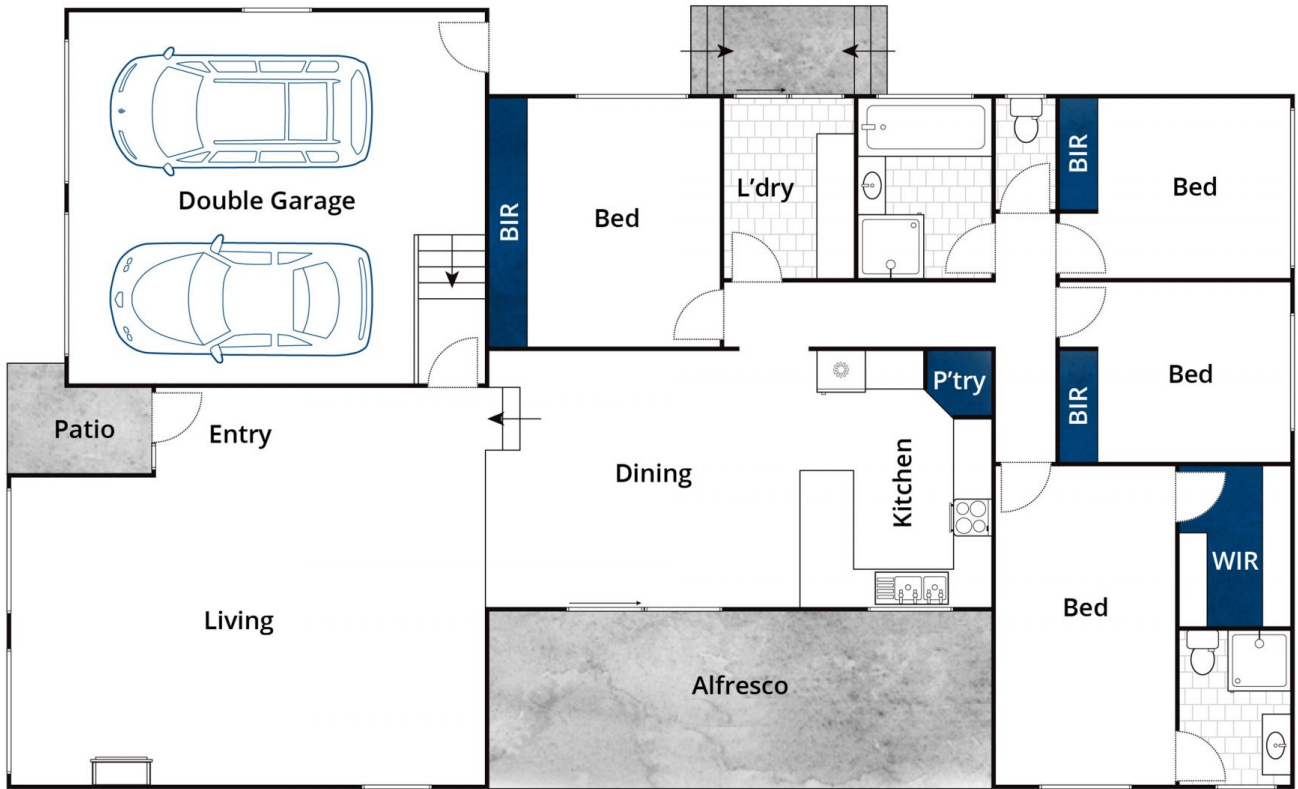

Approx House Area 196m²

Whilst bwrn.com.au has made every attempt to ensure the accuracy of the floor plan contained here, measurements are approximate and no responsibility is taken for any error, omission, or mis-statement. This plan is for illustrative purposes only.

8 Barry Crescent, Goulburn