



**28 Belmore Street Goulburn NSW**

3 1 1

- \* Well-appointed 3 bedroom brick home located in a blue ribbon area and ideally placed between primary and high schools, Hospital, parks and the CBD.
- \* A near new kitchen with plenty of storage and bench space along with an adjoining dining area.
- \* Bathroom with separate bath and shower. Valuable 2nd toilet located off the internal laundry.
- \* Neat and tidy backyard which is well fenced and offer 2 garden sheds for extra storage needs.
- \* Single lock up garage with workshop along with plenty of off street parking.
- \* Homes in this location are so rare and with the flexibility of either investing 'as is' or buying to improve to your liking, this one is not to be missed.

**Type** : House  
**Price** : \$ 617,500  
**Land Size** : 575.4 sqm  
**View** : <https://www.goulburnrealestate.com.au/sale/nsw/southern-tablelands/goulburn/residential/house/6850674>



**Brody Willis**  
02 4822 8711

[For full version visit the website](https://www.goulburnrealestate.com.au)

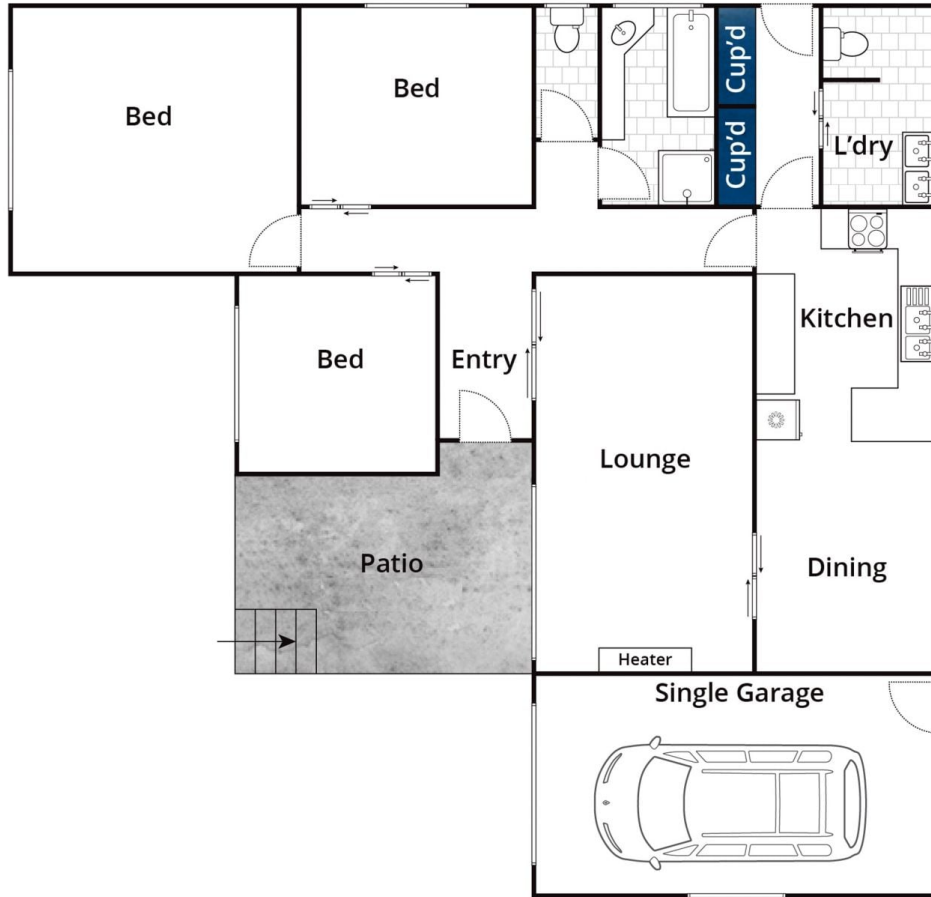

Whilst [bwrn.com.au](http://bwrn.com.au) has made every attempt to ensure the accuracy of the floor plan contained here, measurements are approximate and no responsibility is taken for any error, omission, or mis-statement. This plan is for illustrative purposes only.

## 28 Belmore Street, Goulburn