



88 Goldsmith Street Goulburn NSW

3 1 1

- * Classic federation home circa 1910
- * Located on the door step of the CBD and a stone's throw from the brand-new hospital
- * B4 Mixed Zoning will appeal to buyers looking for commercial usage
- * Flexible floor plan offers up to 4 bedrooms and plenty of living space
- * Charming period features throughout such as high ceilings, picture rails, wide skirting boards and timber architrave capacity as well.

Type : House
Price : \$ 620,000
Land Size : 552 sqm
View : <https://www.goulburnrealestate.com.au/sale/nsw/southern-tablelands/goulburn/residential/house/6760326>

It's business as usual for our team at Goulburn First National. We are adhering to all directions from State and

[For full version visit the website](https://www.goulburnrealestate.com.au)



Barry McEntee
02 4822 8711

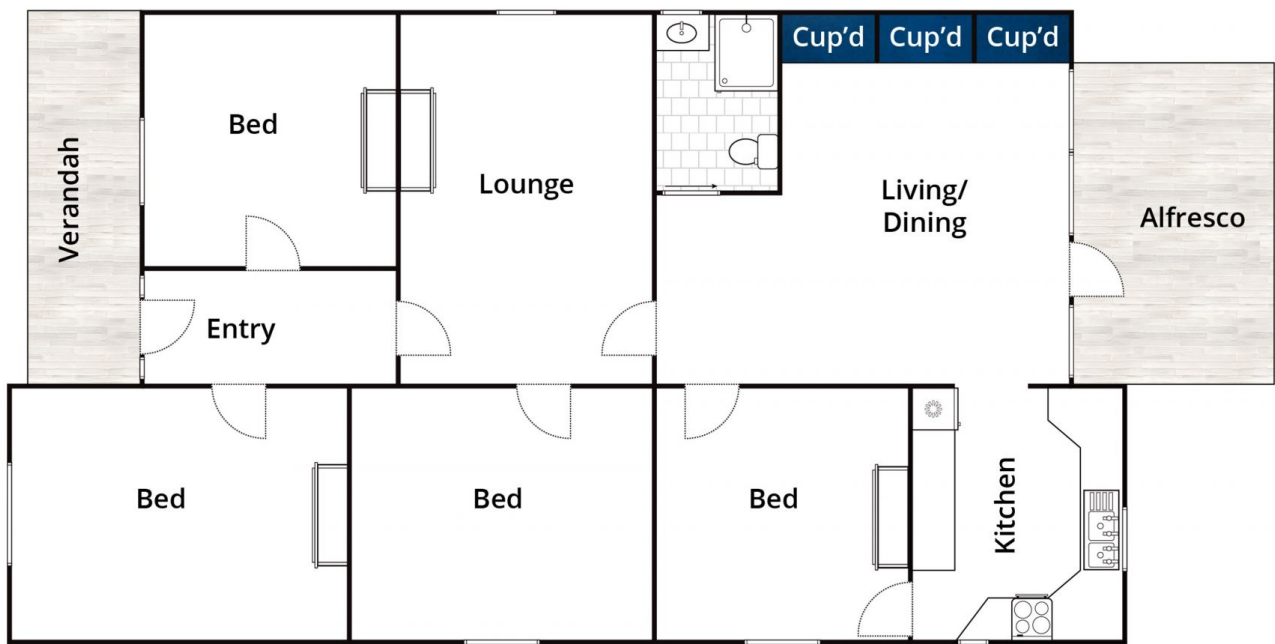

Whilst bwrn.com.au has made every attempt to ensure the accuracy of the floor plan contained here, measurements are approximate and no responsibility is taken for any error, omission, or mis-statement. This plan is for illustrative purposes only.

88 Goldsmith Street, Goulburn

firstnational
REAL ESTATE
Goulburn