



**136 Clifford Street Goulburn NSW**

3 1 2

\* This full brick character home is exceptionally well located in one of the most sought after and established precincts of central Goulburn

\* Victoria Park is just a few hundred metres away with the new Aquatic Centre, walking tracks, rose garden and sporting fields, all of which make this wonderful facility so attractive

\* The CBD is within easy walking distance as are the new hospital and a selection of primary & high schools along with the TAFE college

\* Set on a 702m2 corner block and complete with double garage, the home is very spacious and has plenty of character and charm just waiting for the right buyer to add their own touches and fulfil the enormous potential

\* Each of the 3 bedrooms is a good size and they all have

**Type** : House  
**Price** : \$ 550,000  
**Land Size** : 702 sqm  
**View** : <https://www.goulburnrealestate.com.au/sale/nsw/southern-tablelands/goulburn/residential/house/6738210>



**Barry McEntee**  
02 4822 8711

[For full version visit the website](https://www.goulburnrealestate.com.au)

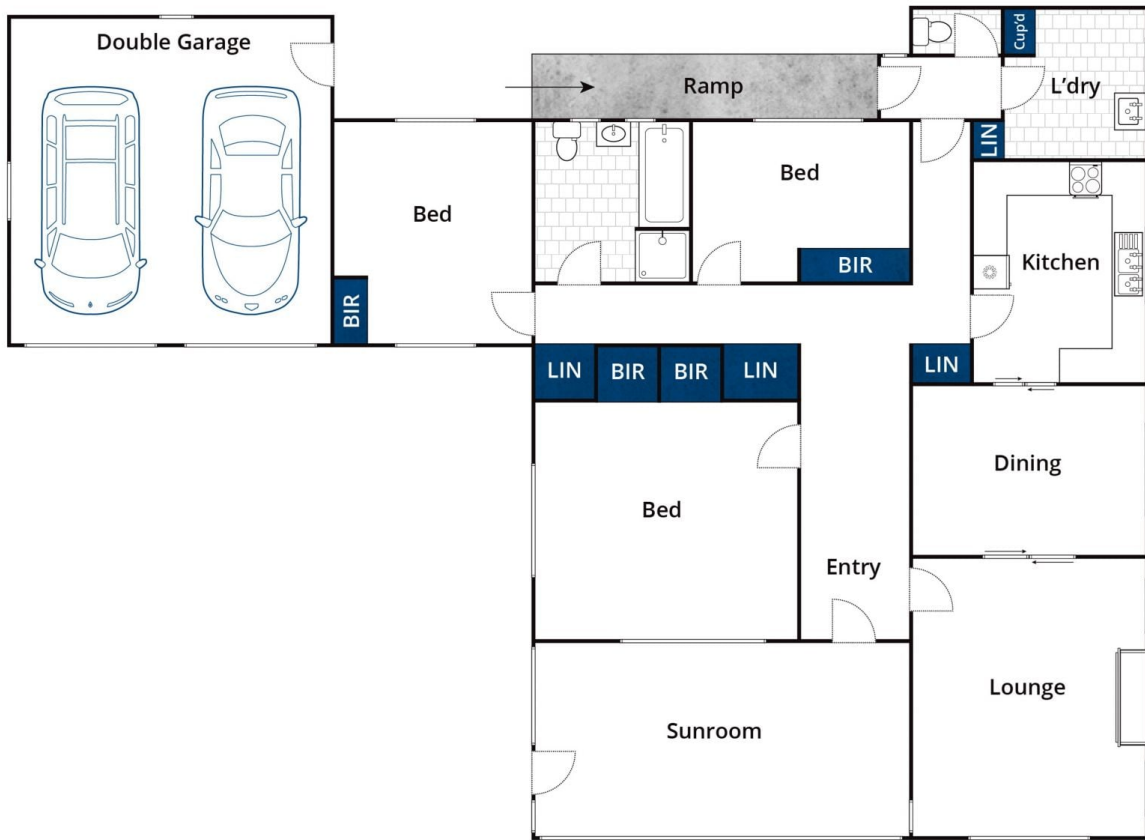

Whilst [bwrm.com.au](http://bwrm.com.au) has made every attempt to ensure the accuracy of the floor plan contained here, measurements are approximate and no responsibility is taken for any error, omission, or mis-statement. This plan is for illustrative purposes only.

## 136 Clifford Street, Goulburn