



8 Lamarra Place Goulburn NSW

4  2  2 

* Set on the high side of the road in a quiet cul-de-sac this established family home is exceptionally well located close to the Marsden Weir and the Wollondilly River Walk

* Just a few minutes drive to the heart of the CBD and within easy walking distance to the Base Hospital, Goulburn High School and Wollondilly Primary School

* The block is 815m2 with good side access to a double lock-up garage and secure yard with an outdoor entertaining area

* The home is very spacious with 4 bedrooms and 3 separate living areas including a delightful sunken lounge room complete with built-in bar plus a large open plan family room and finally, a rumpus room which would be ideal as a children's play room, home office or perhaps a theatre room

Type : House
Price : \$ 700,000
Land Size : 815 sqm
View : <https://www.goulburnrealestate.com.au/sale/nsw/southern-tablelands/goulburn/residential/house/6731473>

[For full version visit the website](https://www.goulburnrealestate.com.au)



Barry McEntee
02 4822 8711

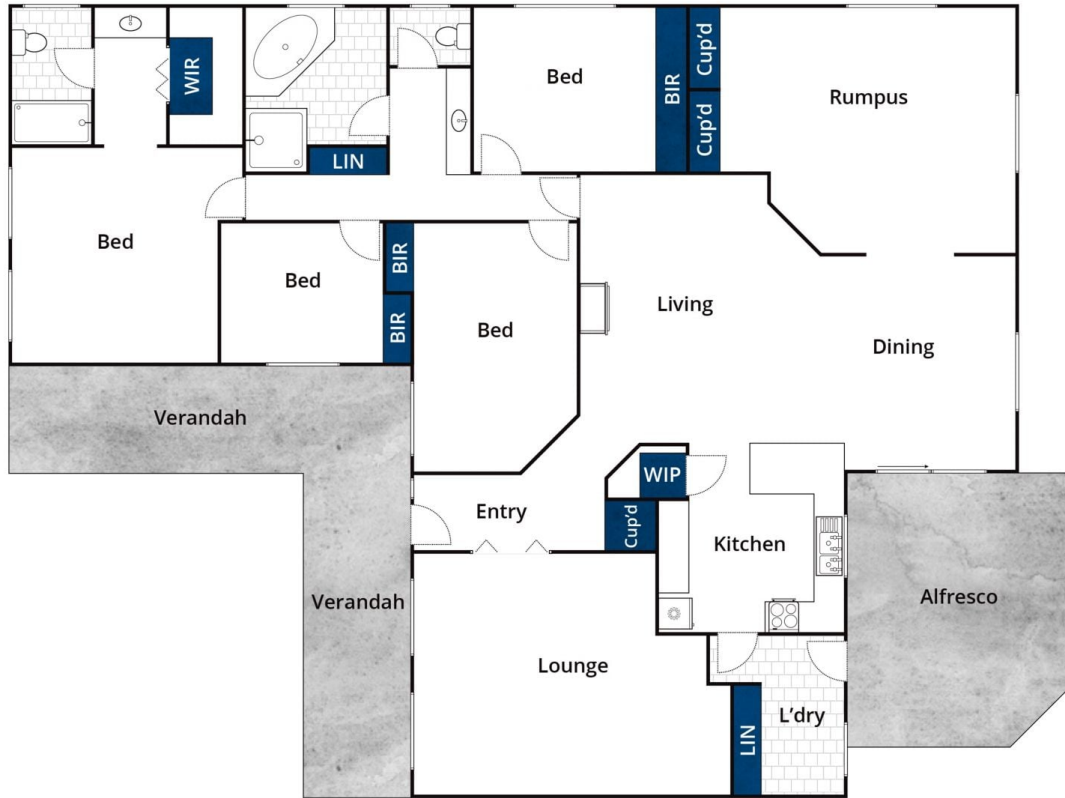

Whilst bwrn.com.au has made every attempt to ensure the accuracy of the floor plan contained here, measurements are approximate and no responsibility is taken for any error, omission, or mis-statement. This plan is for illustrative purposes only.

8 Lamarra Place, Goulburn