



46 Tall Timbers Drive Goulburn NSW

6 2 3

* Without doubt, one of the most usable & level blocks situated in this popular small acreage subdivision. Located just 10 minutes drive to the heart of the CBD with excellent access to the Highway interchange for Canberra commuters.

* This property offers the combination of a tranquil & luscious, 4 acre private hideaway with resort style facilities such as a inground saltwater swimming pool, half basketball court & footy field complete with goal posts that children would dream of enjoying on an annual holiday let alone every day of their lives or when they come to visit Nan & Pop

* However, it's not all about the kids, the Mancave is literally next level - seriously, it has a full tilt bar complete with a pizza oven that overlooks the pool area, the rear

Type : House
Price : \$ 1,410,000
Land Size : 4 Acres
View : <https://www.goulburnrealestate.com.au/sale/nsw/southern-tablelands/goulburn/residential/house/6721040>



Barry McEntee
02 4822 8711

[For full version visit the website](https://www.goulburnrealestate.com.au)

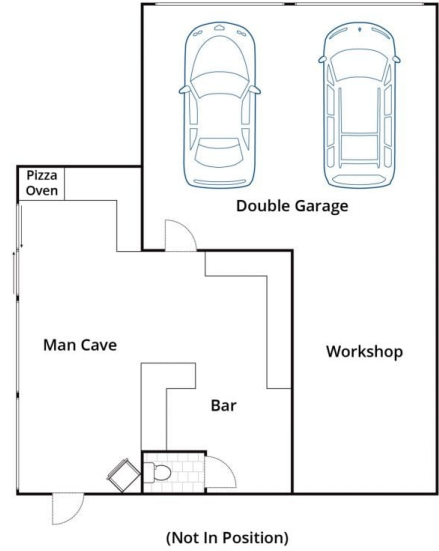

Whilst bwrn.com.au has made every attempt to ensure the accuracy of the floor plan contained here, measurements are approximate and no responsibility is taken for any error, omission, or mis-statement. This plan is for illustrative purposes only.

46 Tall Timbers Drive, Goulburn