



**11 Ruby Street Goulburn NSW**

3 1 2

\* Neat and tidy 3 bedroom home in a superb location close to schools, shops and the popular Wollondilly Walking Track.

\* Large main bedroom with built in wardrobes and timber floorboards throughout with 2 further bedrooms of good size.

\* 2 living spaces with both having access to the covered deck area.

\* Practical kitchen with plenty of cupboard space.

\* Oversize garden shed and single garage as well as a single carport.

\* Low maintenance yard and with a tenant in place. Call to inspect today.

**Type** : House  
**Price** : \$ 503,000  
**Land Size** : 513 sqm  
**View** : <https://www.goulburnrealestate.com.au/sale/nsw/southern-tablelands/goulburn/residential/house/6575483>



**Brody Willis**  
02 4822 8711

[For full version visit the website](https://www.goulburnrealestate.com.au)

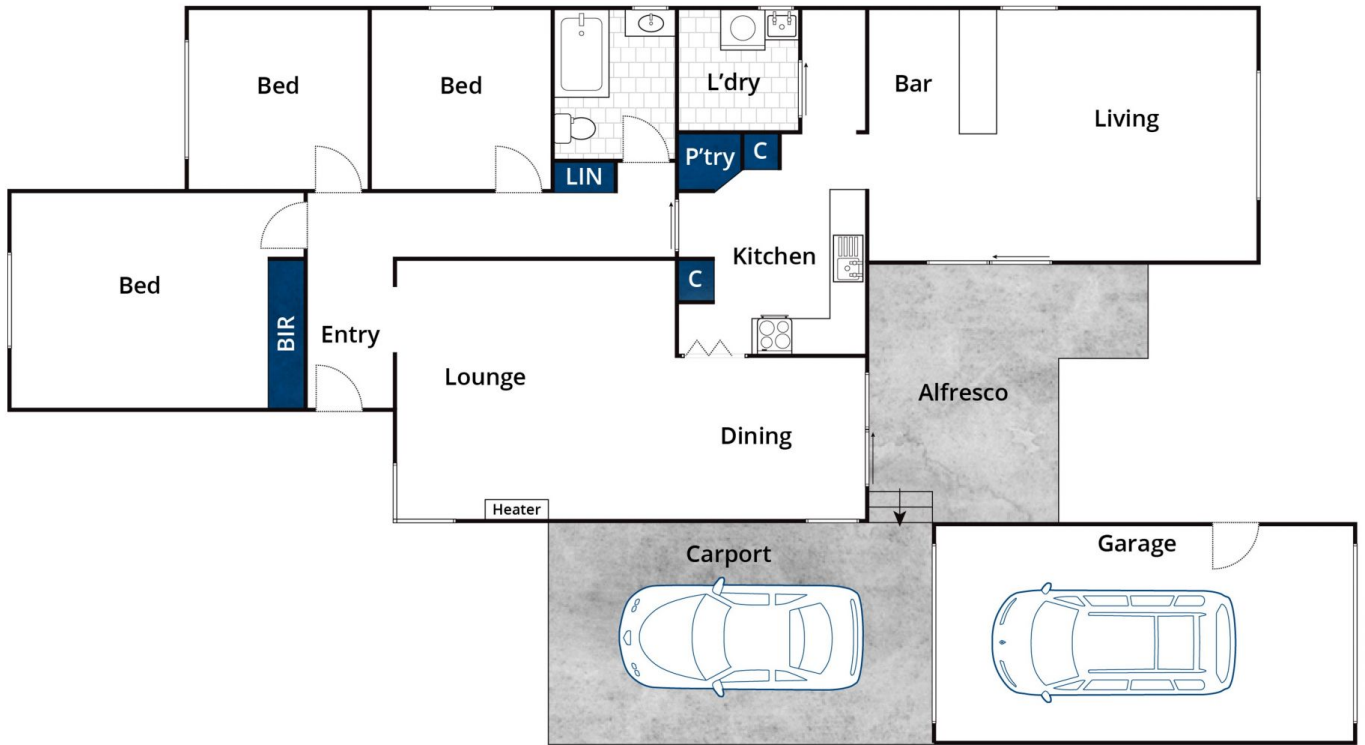

Approx House Area 130m<sup>2</sup>

Whilst [bwrn.com.au](http://bwrn.com.au) has made every attempt to ensure the accuracy of the floor plan contained here, measurements are approximate and no responsibility is taken for any error, omission, or mis-statement. This plan is for illustrative purposes only.

## 11 Ruby Street, Goulburn