





7 Abbey Road Goulburn NSW

5  2  3 

* Oversized and updated family home in one of Goulburn's most sought after residential precincts. Set on over 2000m2 with a brilliant north aspect.

* The home features 4 large bedrooms + study as well as multiple living spaces.

* Stunning kitchen with stone benchtops has loads of storage and work space.

* The entertaining space is a colossal, undercover outdoor area and pool which flows seamlessly off the living and kitchen areas. Plenty of space for guests.

* A triple garage and workshop with a 3rd toilet accessible from the back yard. Plenty of side access for caravans, trailers or even an extra shed.

* Climate controlled with ducted gas heating and evaporative cooling throughout

Type : House
Price : \$ 850,000
Land Size : 2004 sqm
View : <https://www.goulburnrealestate.com.au/sale/nsw/southern-tablelands/goulburn/residential/house/6091315>



Brody Willis
02 4822 8711

[For full version visit the website](https://www.goulburnrealestate.com.au)

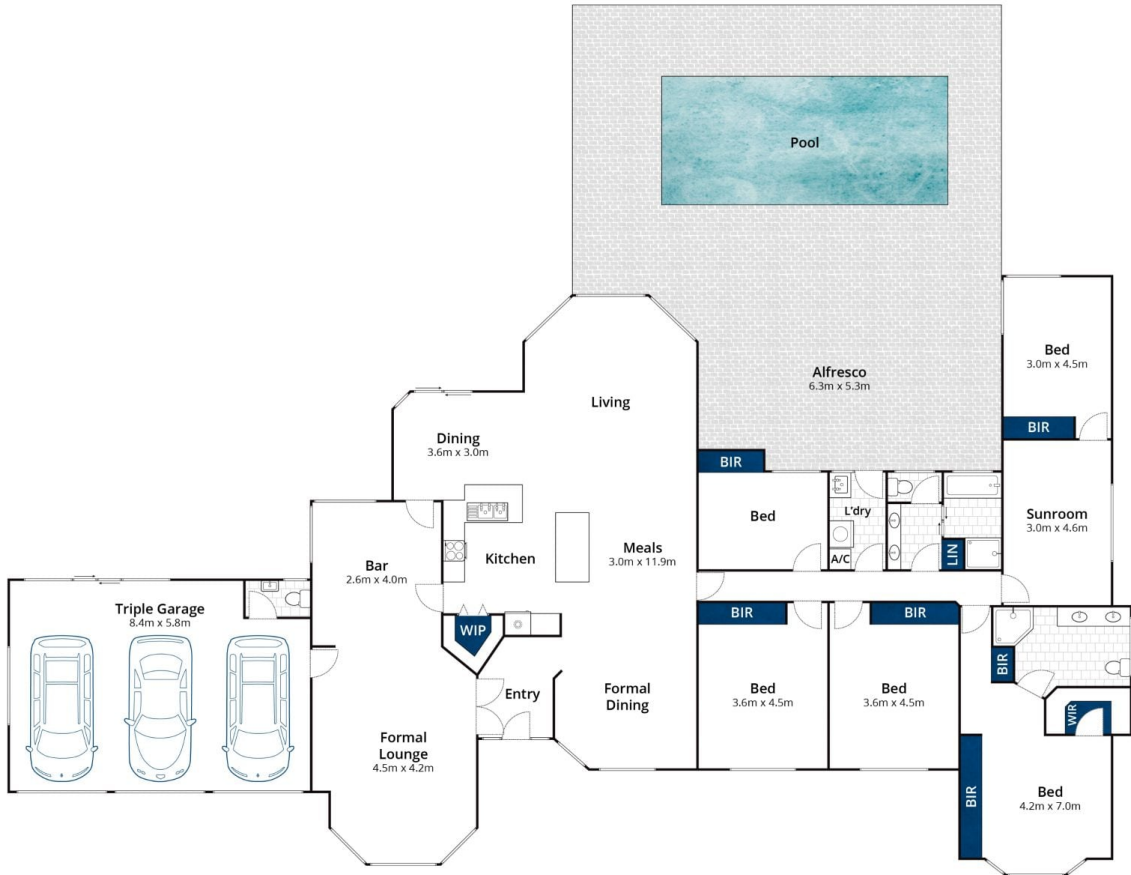

Approx House Area 304m²

Whilst bwrn.com.au has made every attempt to ensure the accuracy of the floor plan contained here, measurements are approximate and no responsibility is taken for any error, omission, or mis-statement. This plan is for illustrative purposes only.

7 Abbey Road, Goulburn